

Drain & Breather
EDB Series

❖ Application

EDB drains and breathers are installed in enclosures or conduit systems to ;

- provide ventilation to minimize.
- condensation.
- drain accumulated condensate.
- at least one breather should be used with such drain.
- A "standard" drain is installed in bottom of enclosure or in lower section of conduit system.
- Breather or drain functions as breathe when mounted at the top of an enclosure, or as a drain when mounted in be bottom of an enclosure.
- drains and breathers are installed in hubs drilled and tapped openings.

❖ Standard Materials

- Stainless Steel

❖ Standard Finish

- Natural
- If you want another color, contact us please.

❖ Certificate

- Ex db IIC Gb / Ex eb IIC Gb / Ex tb IIIC Db
- IECEX INE 12.0050U
- INERIS 12 ATEX 9011U

❖ Ordering Information

EDB	/*	1501	/	*	1
①	②	③	④	⑤	

① EDB Drain and Breather

② Exp. Type

None	Ex d Type
e	Ex e Type

③ 1501 Type

④ Thread Type

M	Metric
N	NPT
P	PF

⑤ Thread Size

	NPT / PF	Metric
1	1/2"	M20

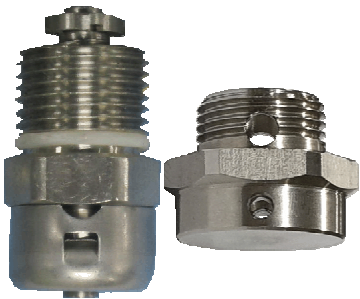

❖ Dimension

