

Junction Boxes with Union Hubs EOS Series

❖ Type of Explosion-proof
Flameproof (Ex d IIC)

❖ Dimension



< EOS >

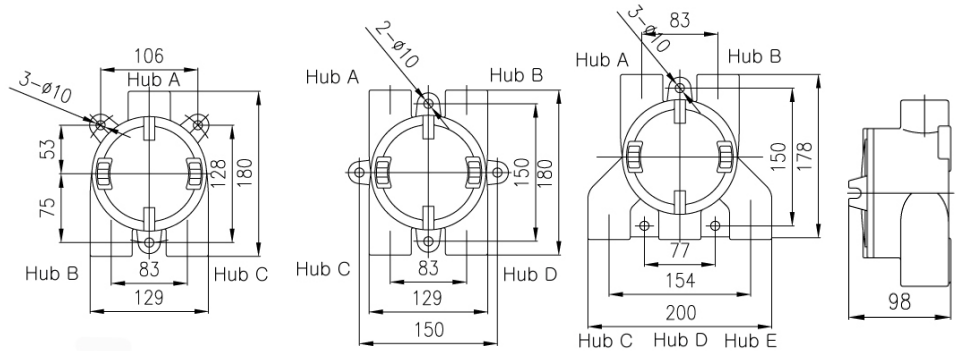

❖ Application

EOS Series junction boxes with union hubs are used ;

- in Threaded rigid conduit systems in hazardous areas
- to allow easy disassembly of conduit system
- to function as junction and pull box for multiple conductors and conduits
- in Indoors or outdoors where space is limited, such as in gasoline pumps

❖ Features

- Supplied with union hubs which makes it a compact assembly
- Have a variety of hub arrangements
- Covers are threaded
- Mounting straps are standard on all boxes

❖ Standard Materials

- Body : Cast Iron
- Cover : Cast Aluminium Alloy

❖ Compliance & Certification

- IEC 60079-0, 1
- Certified by KOSHA (Korea Occupational Safety & Health Agency), KGS (Korea Gas Safety Corporation), and the others.

❖ Size Range

- 1/2" ~ 1" Hub

❖ Standard Finish

- Cast Iron : Hot Dip Galvanized with stove enamelled
- Cast Al : MUNSELL NO.7.5BG 6/1.5

❖ Ordering Number

Hub Size					Ordering Number with Nuts and Sleeves
A	B	C	D	E	
1/2"	1/2"	1/2"			EOS 3000
3/4"	3/4"	3/4"			EOS 3111
1/2"	3/4"	3/4"			EOS 3011
3/4"	1/2"	1/2"			EOS 3100
3/4"	1"	1"			EOS 3122
3/4"	1"	3/4"			EOS 3121
1"3/4"	3/4"				EOS 3211
1"3/4"	1"				EOS 3212
1"1"	1"				EOS 3222
3/4"	3/4"	3/4"	3/4"		EOS 41111
3/4"	3/4"	3/4"	3/4"	3/4"	EOS 511111
3/4"	3/4"	3/4"	3/4"	3/4"	EOS 511111

❖ Ordering Information

EOS 4 1111
① ② ③

① : EOS Junction Box

② : Nos. of Hub

③ : Hub Size

0 : 1/2"

1 : 3/4"

2 : 1"

(Marking In order of top left to top right, bottom left to bottom right)

⇒ If you need more information, contact us please.